



Luke Williams
real estate



23 Donaldson Drive Warrnambool VIC

5 3 4

A captivating central oasis awaits at 23 Donaldson Drive, with decadent high ceilings, flawless presentation and unique character elevating this property beyond expectation. Nestled in a quiet, central pocket of Warrnambool this home is sure to impress; from the exterior to the interior, all the boxes are ticked, it doesn't get better than this. Step inside to the open plan kitchen, living and dining area and let your eyes wander. From the Oregon beams trailing across the ceiling to the exposed brick, with a pine wood feature wall tying this masterpiece together. A rare yet stunning combination of materials has gone into producing this haven.

The kitchen is equipped with all your necessary appliances, such as a dishwasher, double sink and 900 mm oven. The

[For full version visit the website](https://www.lukewilliamsrealestate.com.au/sale/vic/warrnambool-port-fairy/warrnambool-residential/house/8141018)

Type : House
Price : Contact Agent
Land Size : 3371 sqm
View : <https://www.lukewilliamsrealestate.com.au/sale/vic/warrnambool-port-fairy/warrnambool-residential/house/8141018>



Luke Williams
0438 305 533



Rihanna MacDonald
0490 078 647

<https://www.lukewilliamsrealestate.com.au>

23 Donaldson Drive, Warrnambool

23 Donaldson Drive , Warrnambool
FLOORS: 2

The measurements provided in this real estate floor plan are intended to serve as a general guide and for marketing purposes only. While every effort has been made to ensure accuracy, these measurements are not intended to be relied upon for any purpose, and should not be considered a guarantee of precise dimensions or square footage.

▼ Ground Floor



▼ 1st Floor

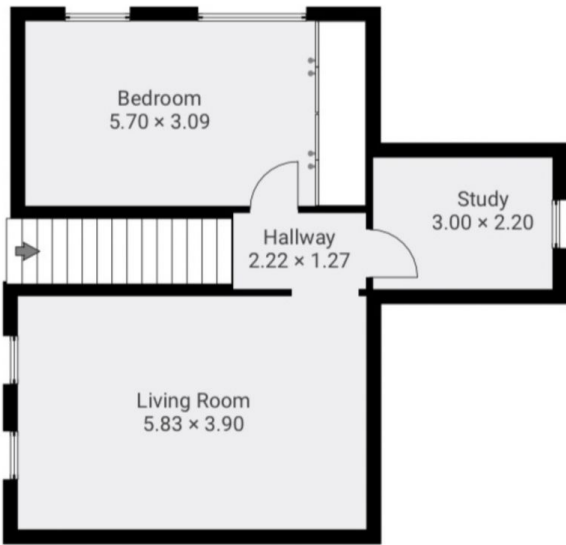

LukeWilliams
real estate